

# SHOT FOLDING+39

## ISTRUZIONI DI MONTAGGIO ASSEMBLY INSTRUCTIONS

MODELLO:  
MODEL:

411/39.1130.25 F

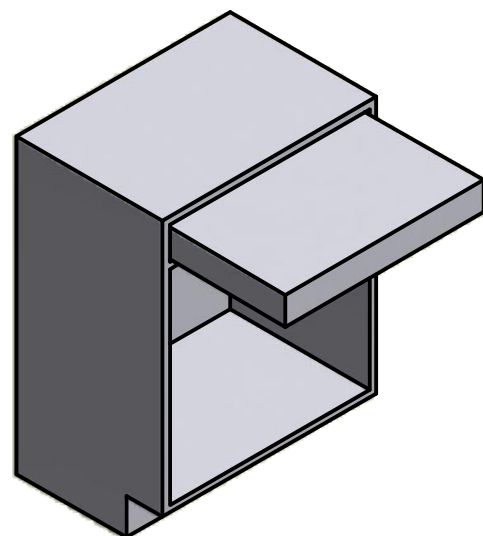

## CONTENUTO DELLA CONFEZIONE INCLUDED IN THE PACKAGING

GUIDE  
SLIDES

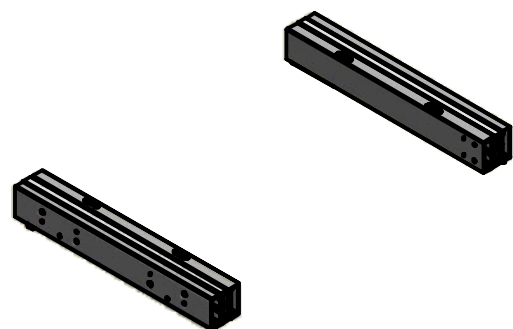

### SACCHETTO ACCESSORI - ACCESSORIES

- A. Chiave esa. n.5 - n.5 Allen key
- B. Chiave esa. n.4 - n.4 Allen key
- C. Squadra - Bracket (x 4)
- D. Bussola M6 12x8 mm - M6 12x8 mm bush (x 8)
- E. Vite TCCE M6x12 - M6x12 SHCS screw (x 8)
- F. Vite TPS M6x60 - M6x60 FHCS screw (x 4)

## DIMENSIONI GENERALI GENERAL DIMENSIONS

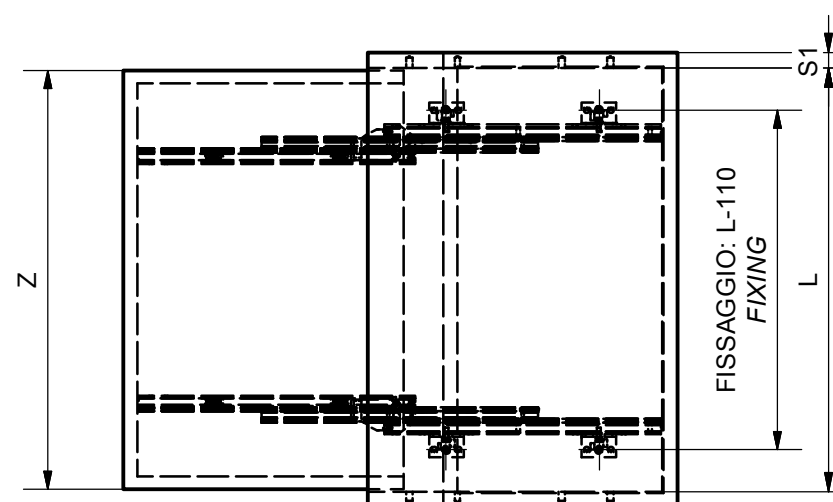
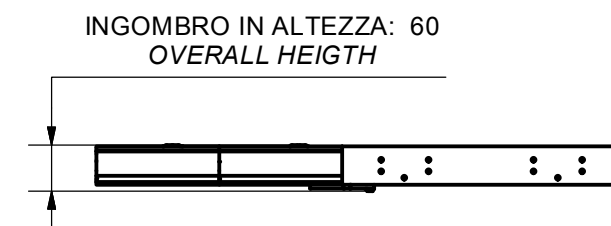
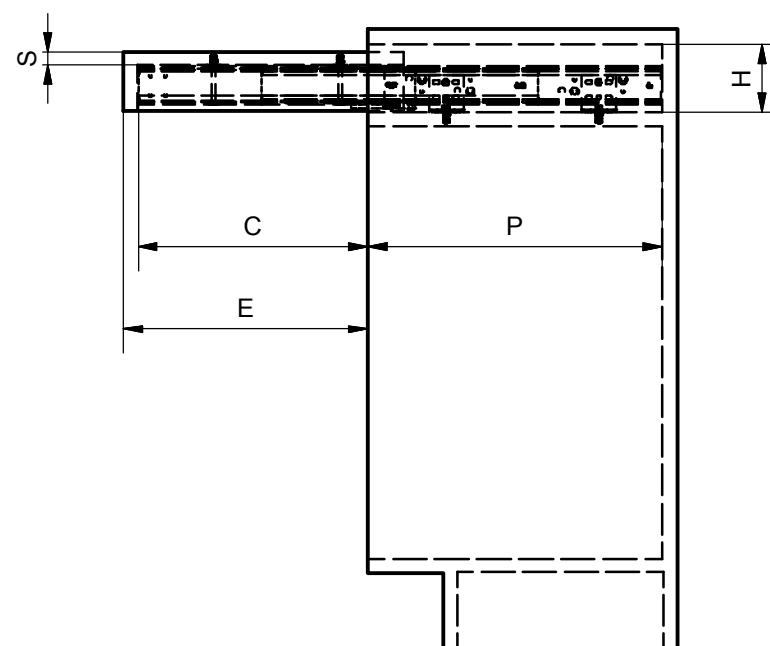

INTERASSE FORI FISSAGGIO TOP  
SPACE BETWEEN TOP FIXING HOLES  
Z - 233.5



DIMENSIONE - DIMENSION	SIMBOLO - SYMBOL	mm
ALTEZZA - HEIGHT	H	MIN: 90
PROFONDITA' - DEPTH	P	MIN: 390
LARGHEZZA - WIDTH	L	MIN: 410 MAX: 1170
SPESSORI PIANO - TOP THICKNESS	S	MIN: 16
SPESSORI SPALLE - SIDE THICKNESS	S1	15-20
LARGHEZZA PIANO - TOP WIDTH	Z	L - 5
APERTURA PIANO - TOP OPENING	E	325
APERTURA MECCANISMO - MECHANISM OPENING	C	303

# POSIZIONE FORI FISSAGGIO HOLES FOR POSITION

# DIMENSIONI PIANO TOP DIMENSIONS

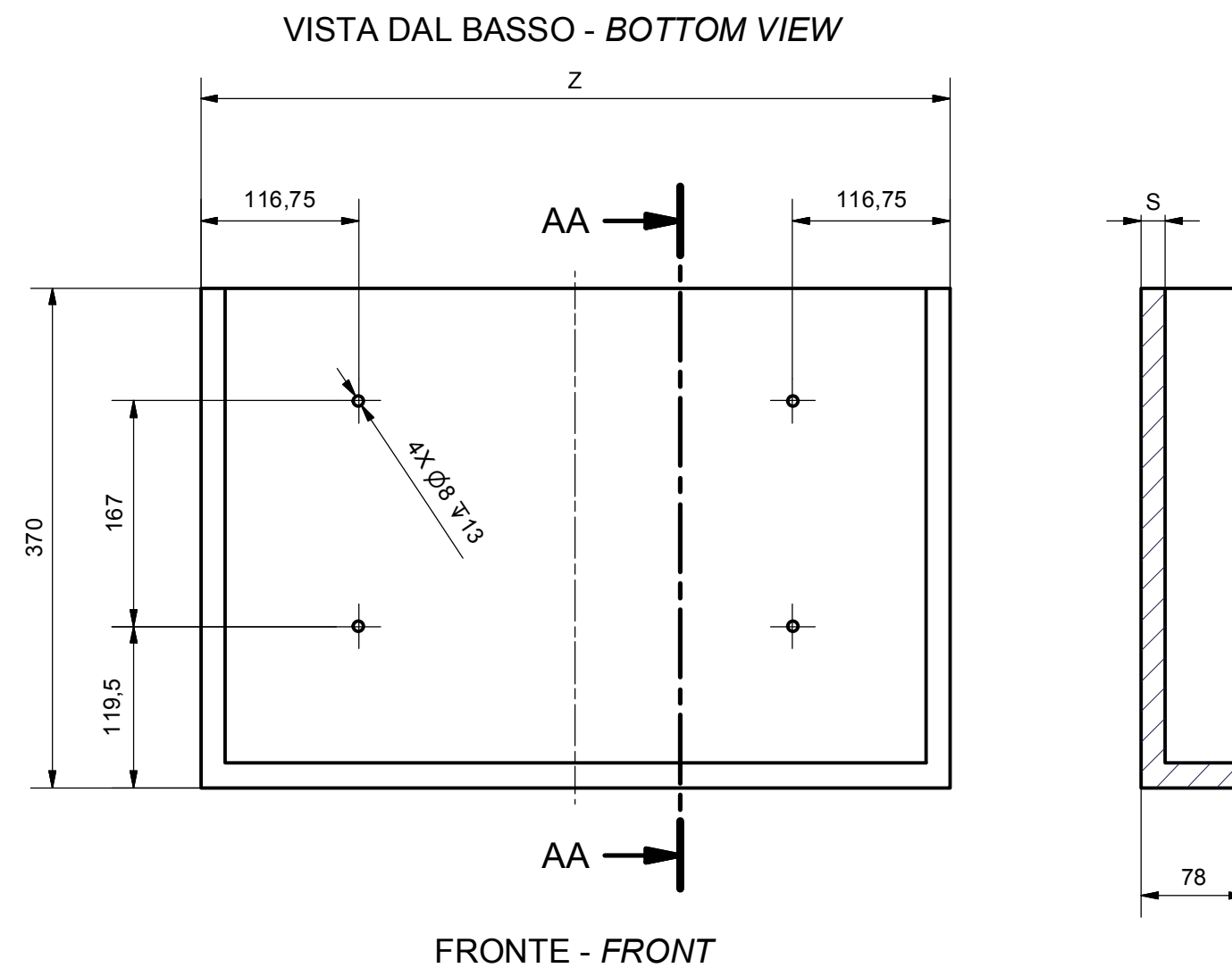
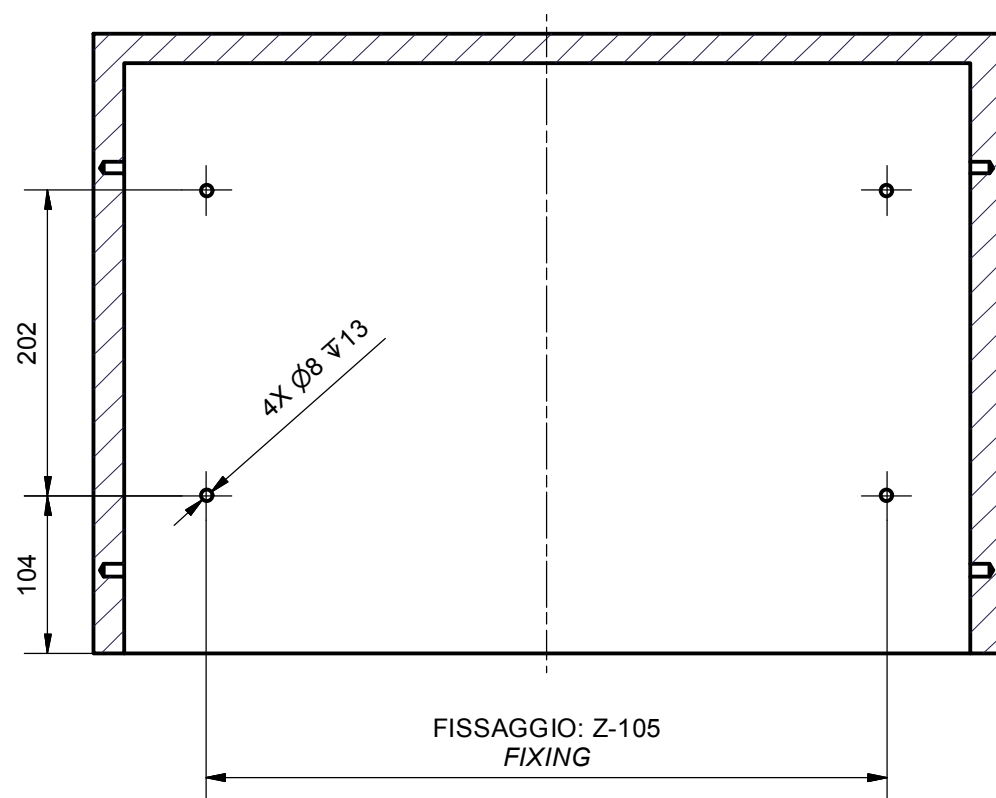
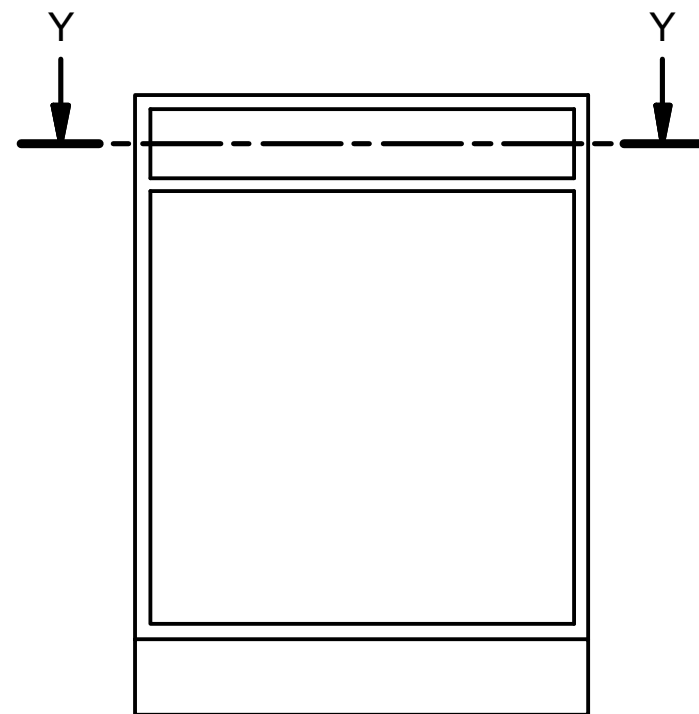

D. Bussola M6 12x8 mm - M6 12x8 mm bush (x 12)

# MONTAGGIO SUL MOBILE MOUNTING ON THE CABINET

# SEQUENZA DI FUNZIONAMENTO FUNCTIONING STEPS

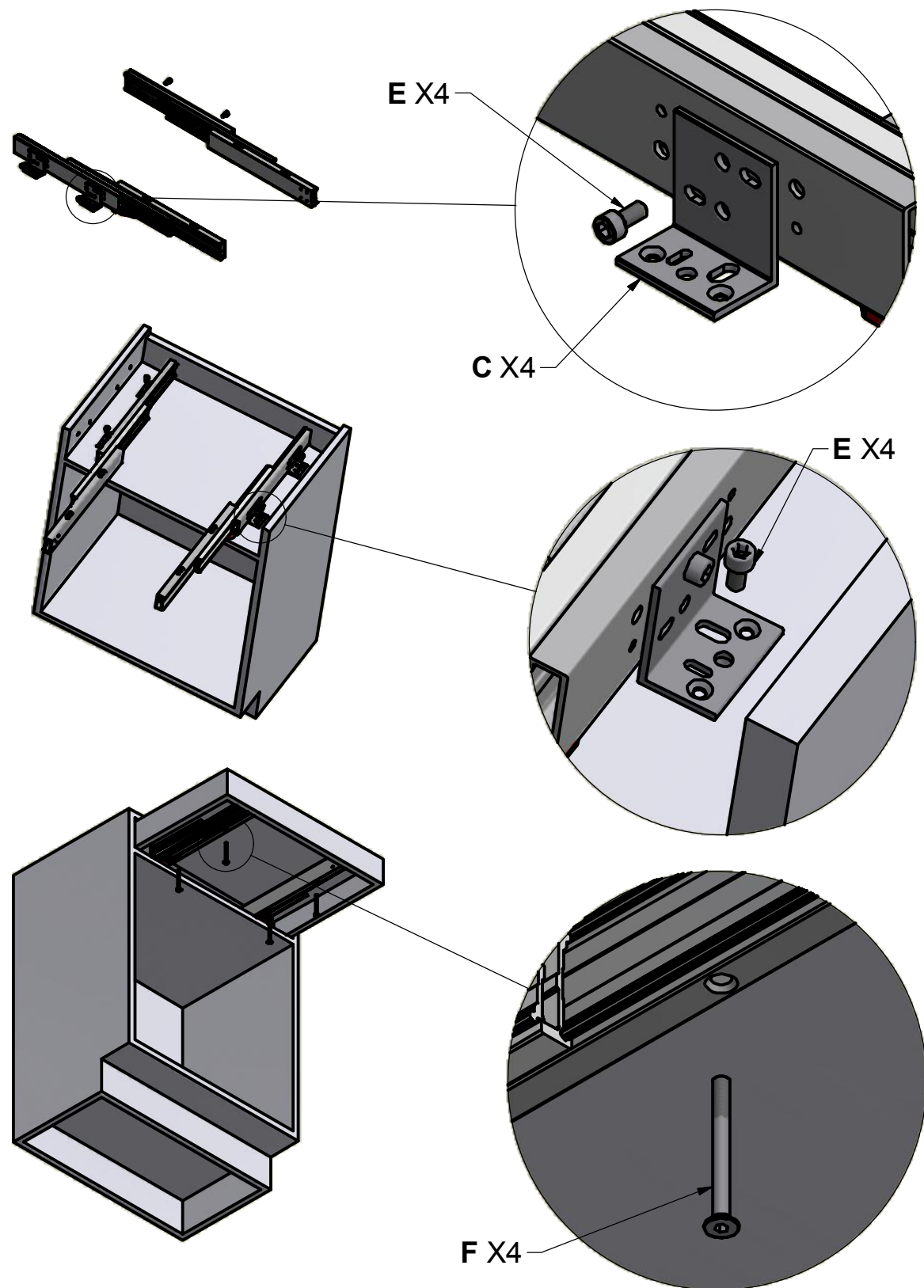

- C. Squadra - Bracket (x 4)
- E. Vite TCCE M6x12 - Socked head cap screw M6x12 (x 8)
- F. Vite TPS M6x60 - M6x60 Tapered screw (x 4)

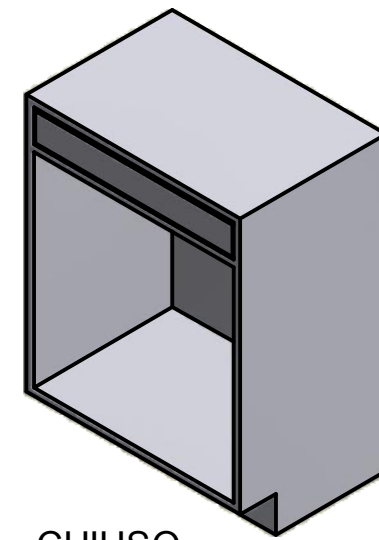

CHIUSO  
CLOSED

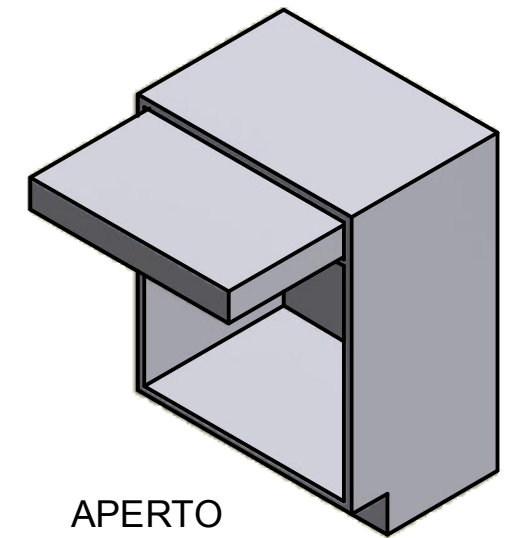

APERTO  
OPENED

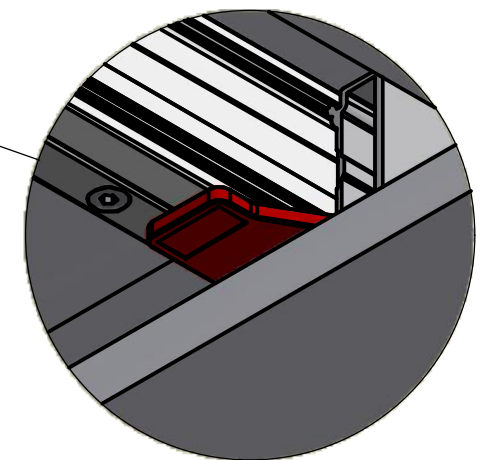
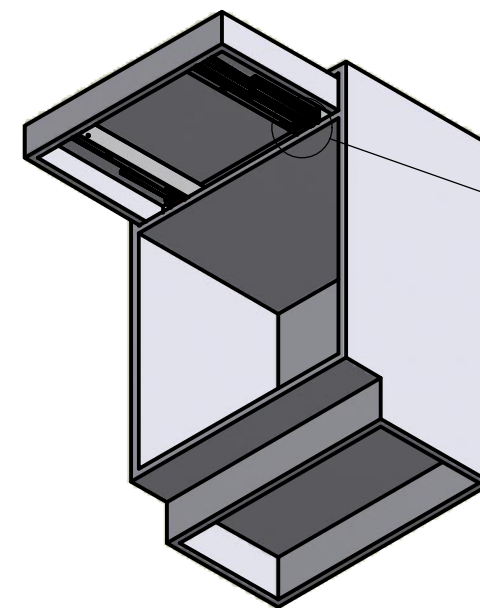

PER CHIUDERE IL MECCANISMO SPINGERE LE DUE  
LEVE ROSSE IN PLASTICA VERSO L'INTERNO  
TO CLOSE THE MECHANISM PUSH TOWARD THE  
INSIDE THE TWO RED PLASTIC PARTS