

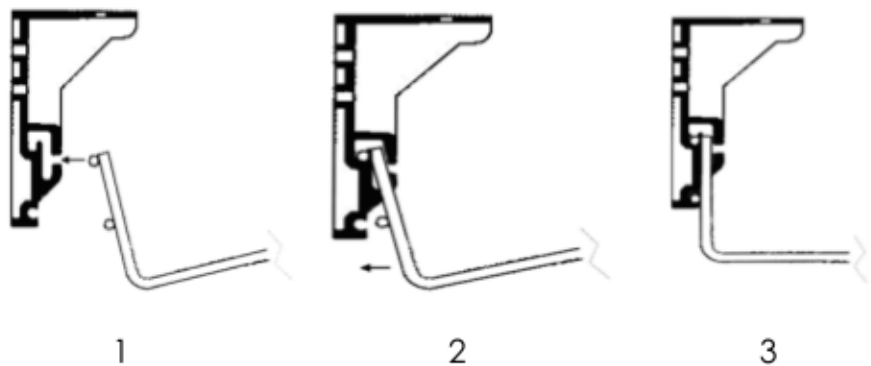

www.bpfonline.co.uk

Basket Mounting Instructions

Please note the same bracket is used for both 'Underdesk' (Top) and Modesty Panel (H) Fixing.



If extra space is needed to access sockets etc Basket may be moved to position 5 whilst access is required – Always return to position 3 when work completed

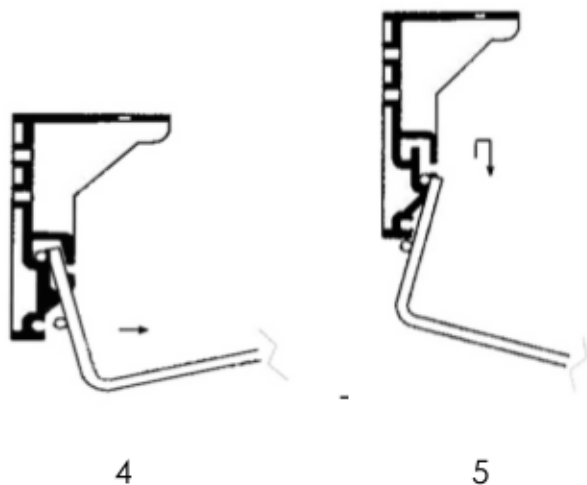

INSTALLER –PLEASE LEAVE THIS SHEET WITH END USER